

E-263400  
N-425000

VCL 1074 PAGE 215

FUTURE EXPANSION

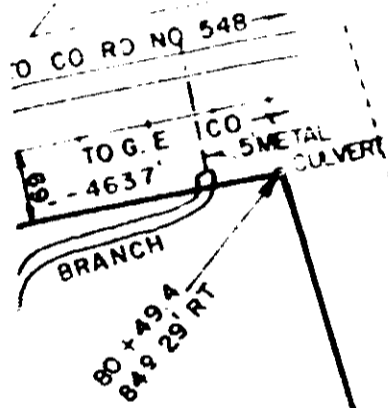

INCOMING LINE  
N35°37'E

REF WING NO 104-182  
S 12° 19' 51" E - 909.9'

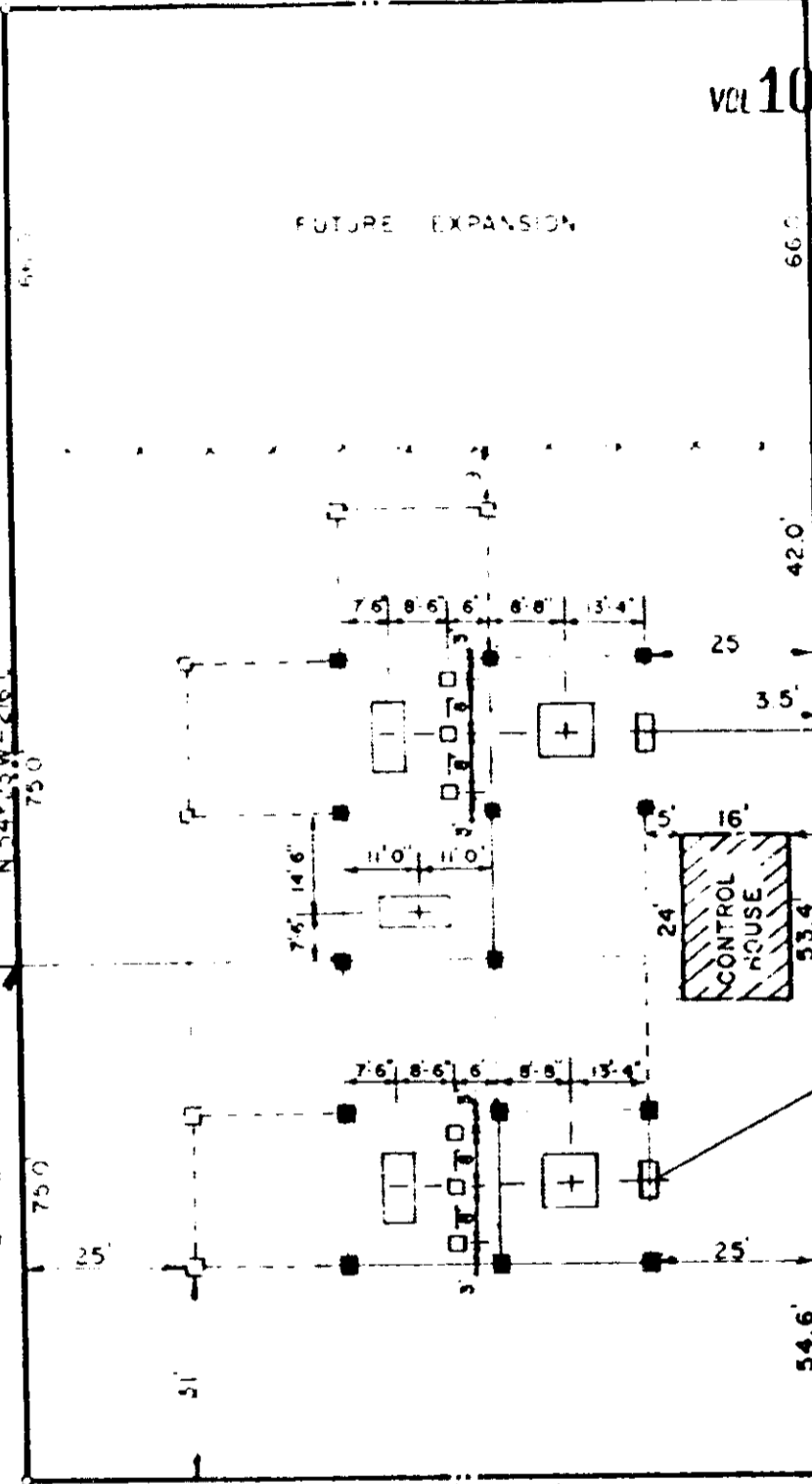

PLANT GRID

E-2850.00  
N-4250.00

S 35° 37' W - 16.0'

PANY

ADDITIONAL STRUCTURE  
 ED 4-19-68  
 WING LINE REVISED 4-24-68  
 " " 7-6-77  
 " " 8-15-77

89+59.3  
728.08 LT  
90+34.3  
LOT LINE

N35°37'E-75.0'



NOTE FOR DETAILS OF  
 SUBSTATION LOT  
 SEE ABOVE  
 948.42'

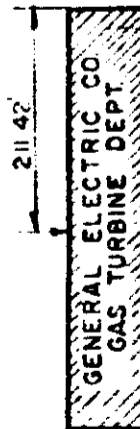

*Ronald M. Linnell*  
 S.C., R.L.S. No. 5387  
 Duke Power Co.  
 Charlotte, NC



CONTROL HOUSE REVISED 6-10-68

21967

157-68  
 RECORDED FEB 24 1978 At 10:48 A.M.

4328 RV.2

0218